



INSTRUCTION BULLETIN

No. 340135
Machine: 4300
Published: 12-98/00
System: OPTIONS

NOTE: DO NOT DISCARD the Parts List from the Instruction Bulletin. Place the Parts List in the appropriate place in your machine manual for future reference. Retaining the Parts List will make it easier to reorder individual parts and will save you the cost of ordering an entire kit.

NOTE: Numbers in parenthesis () are reference numbers for parts listed in Bill of Materials.

Installation instructions for kit number 367611

SYNOPSIS / PROBLEM:

This kit contains the parts needed to install a broom holder kit on the model ATLV 4300. Please follow step-by-step instructions.

SPECIAL TOOLS / CONSIDERATIONS: Hand drill, .34in. dia. (11/32) drill bit

(Estimated time to complete: 1 hour)

PREPARATION:

(Refer to FIG. 1 and 2)

FOR SAFETY: Before leaving or servicing machine, stop on level surface and set parking brake. Then turn off machine and remove key.

1. Turn off machine and set parking brake.

INSTALLATION:

(Refer to FIG. 1 and 2)

1. Place broom holder (1) in mounting position on fender, hanging approx .375in. over fender.
2. Using broom holder (1) as a template, mark two mounting holes in right rear fender of machine. (Refer to FIG. 1)
3. Drill two .34in. dia. (11/32) holes in rear fender in locations marked with template. (Refer to FIG. 1)
4. Mount broom holder (1) with hex screws (2), washers (3) and nuts (4). (Refer to FIG. 1 and 2)

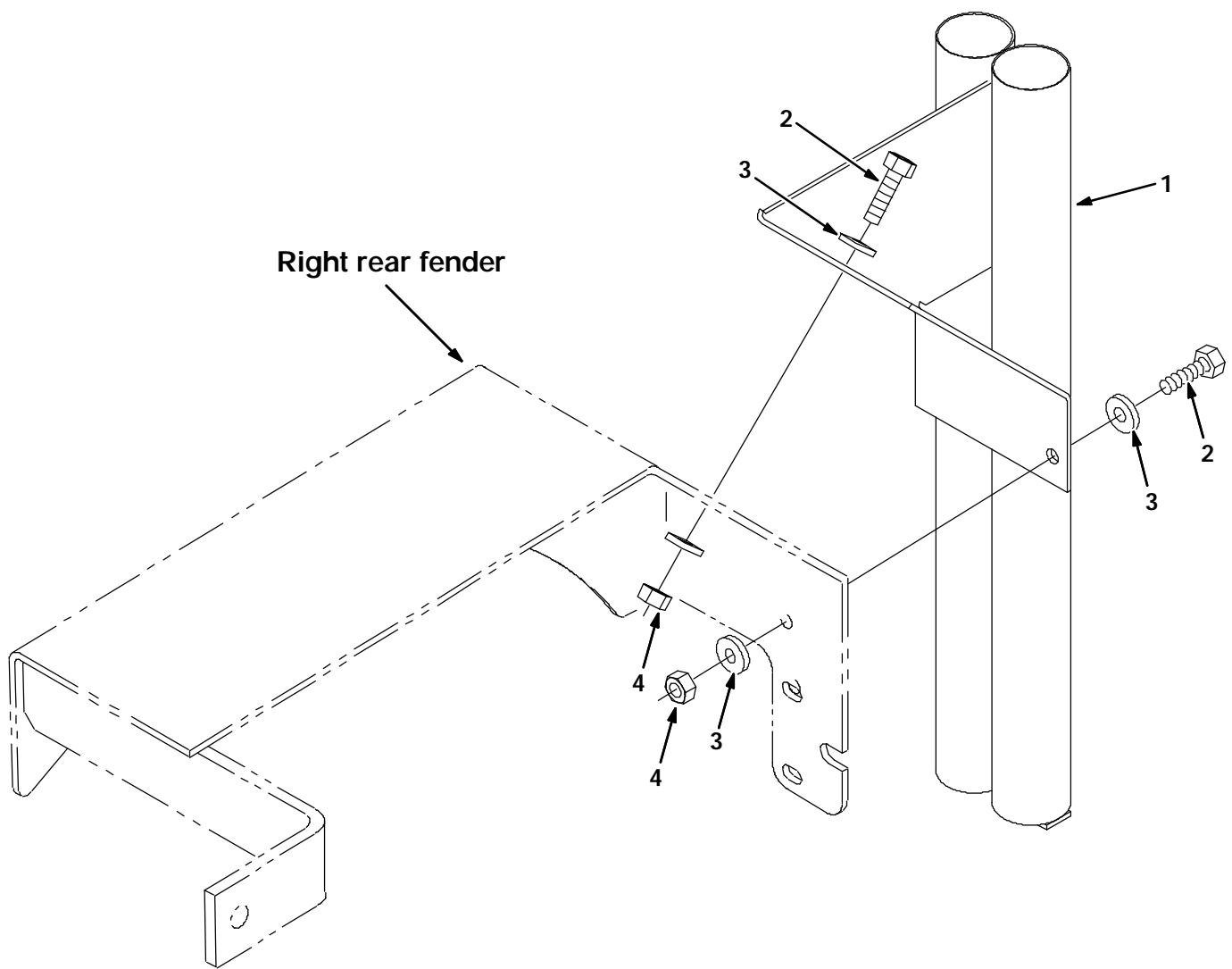

FIG. 1 - BROOM HOLDER KIT BREAKDOWN

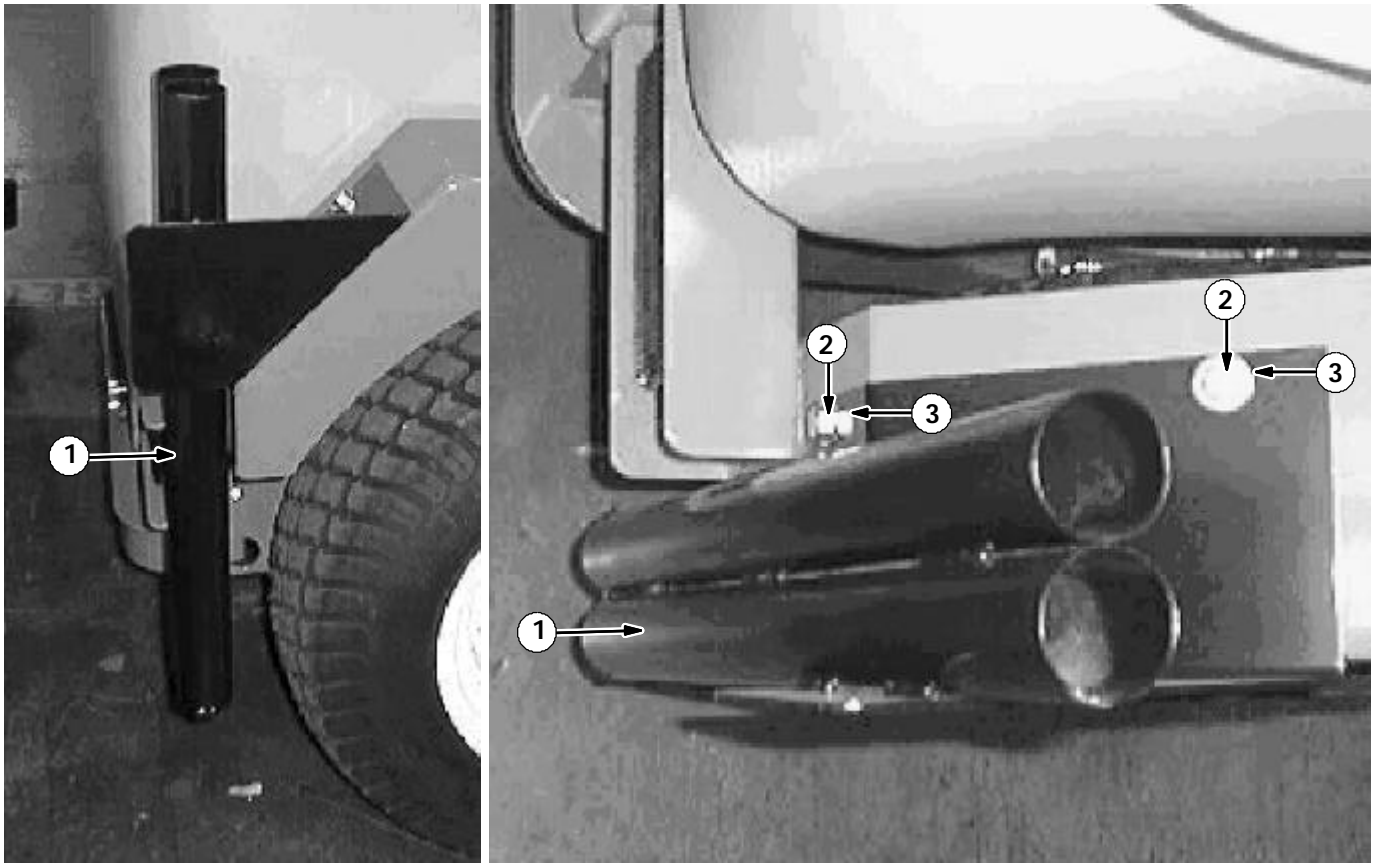

FIG. 2 - BROOM HOLDER KIT INSTALLATION

BILL OF MATERIALS FOR BROOM HOLDER KIT 367611

Ref.	TENNANT Part No.	Description	Qty.
1	367744	Bracket wldt, broom holder	1
2	09740	Scr, hxssm 8 X 1.25 20se	2
3	01685	Washer, flt .31ss se	4
4	07791	Nut, hx flng M 8 X 1.25se	2

TENNANT COMPANY
P. O. Box 1452
Minneapolis, MN 55440-1452